

The UPS cabinets use forced air cooling to regulate internal component temperature. Air inlets are in the front of the cabinet and outlets are in the top. Allow clearance in front of and above each cabinet for proper air circulation. The clearances required around the UPS cabinet are shown in Table 3-2. Dimensions are in millimeters (inches).

Table 3-2. UPS Cabinet Clearances

From Top of Cabinet	457.2 mm (18") minimum clearance for ventilation
From Front of Cabinet	914.4 mm (36") working space
From Back of Cabinet	None Required
From Right Side of Cabinet	152.4 mm (6") working space
From Left Side of Cabinet	None Required (If installing without a FI-UPM, it is recommended to leave a space of at least 915 mm (36") to accommodate a FI-UPM for future capacity upgrade.

The basic environmental requirements for operation of the UPS are:

- Ambient Temperature Range: 0–40°C (32–104°F)
- Recommended Operating Range: 20–25°C (68–77°F)
- Maximum Relative Humidity: 95%, non-condensing



CAUTION

If Eaton battery cabinets are located in the same room as the UPS, the battery cabinet environmental requirements supersede the UPS requirements. Operating temperatures above the recommended range will result in decreased battery life and performance, and will reduce or void the battery warranty. Refer to Eaton's *Terms and Conditions of Sale with Battery Replacement Coverage* and the *Battery Replacement Price Book* for more information. These documents can be found at www.eaton.com/powerquality or contact an Eaton service representative to obtain copies.

The UPS ventilation requirements are shown in Table 3-3.

Table 3-3. Air Conditioning or Ventilation Requirements During Full Load Operation

Rating	Input/Output Voltage	Heat Rejection BTU/hr × 1000/ (kg-cal/hr)	Ventilation Required for Cooling Air Exhaust
450 kVA	400/400	87 (21886)	Approximately 1652 liter/sec (3500 CFM)
	480/480	88 (22107)	
500 kVA	400/400	96 (24318)	With Field Installed UPM Approximately 2478 liter/sec (5250 CFM)
	480/480	97 (24563)	
550 kVA	400/400	106 (26479)	
	480/480	107 (27020)	

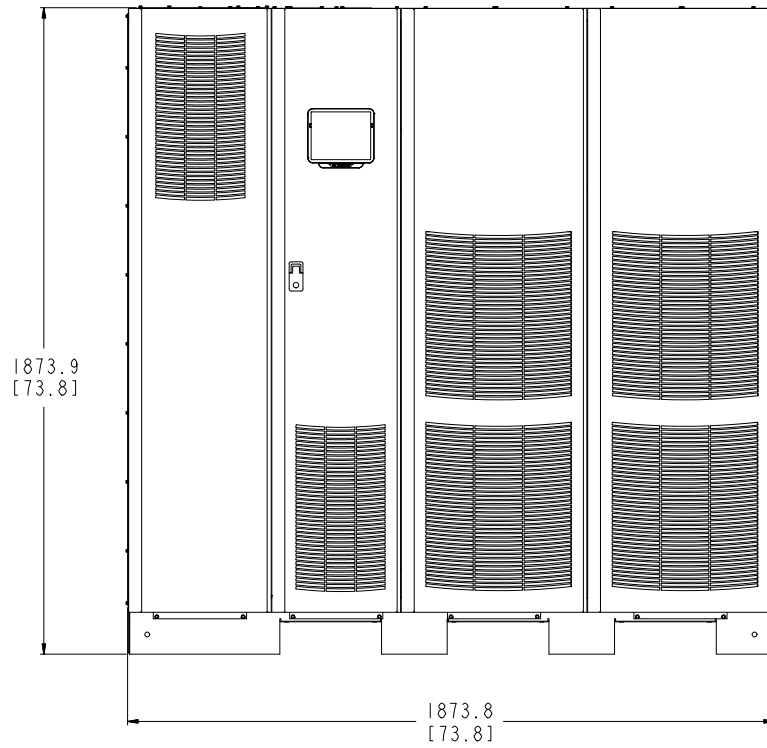

Dimensions are in millimeters [inches].

Figure 3-1. UPS Cabinet Dimensions (Front View)

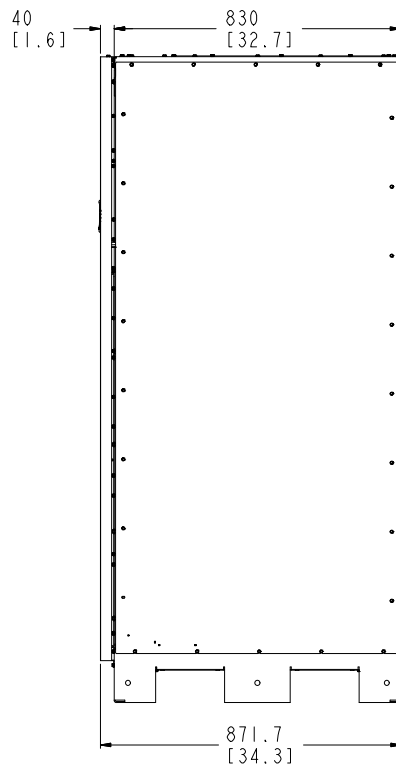

Dimensions are in millimeters [inches].

Figure 3-2. UPS Cabinet Dimensions (Right Side View)

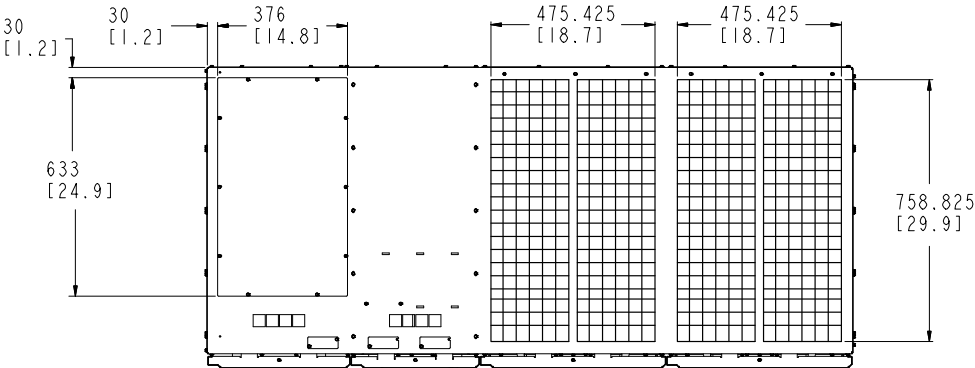

Front
Dimensions are in millimeters [inches].

Figure 3-3. UPS Cabinet Dimensions (Top View)

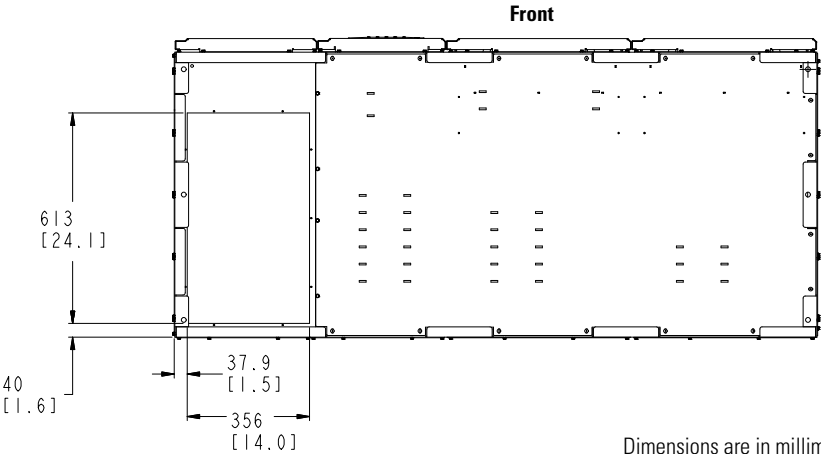

Dimensions are in millimeters [inches].

Figure 3-4. UPS Cabinet Dimensions (Bottom View)

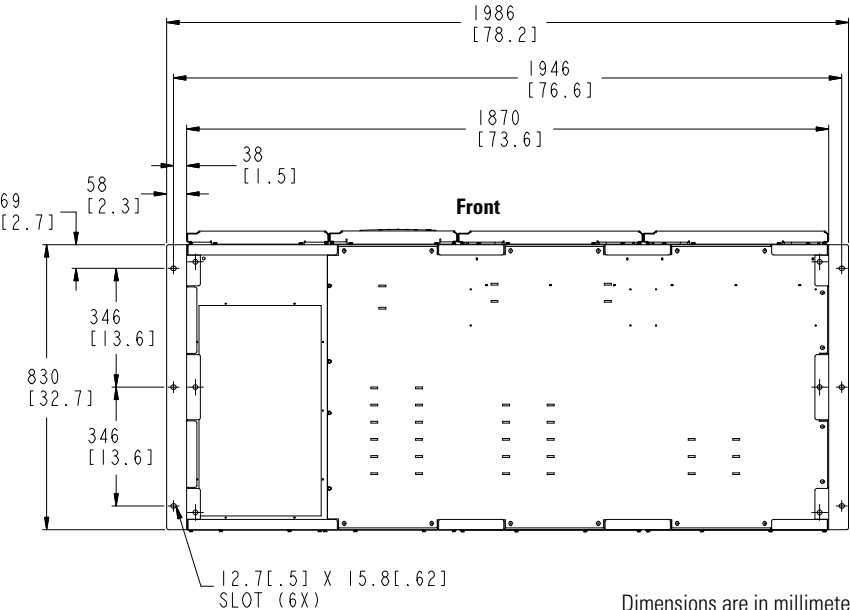

Dimensions are in millimeters [inches].

Figure 3-5. UPS Cabinet Dimensions (Bottom View with Mounting Brackets)

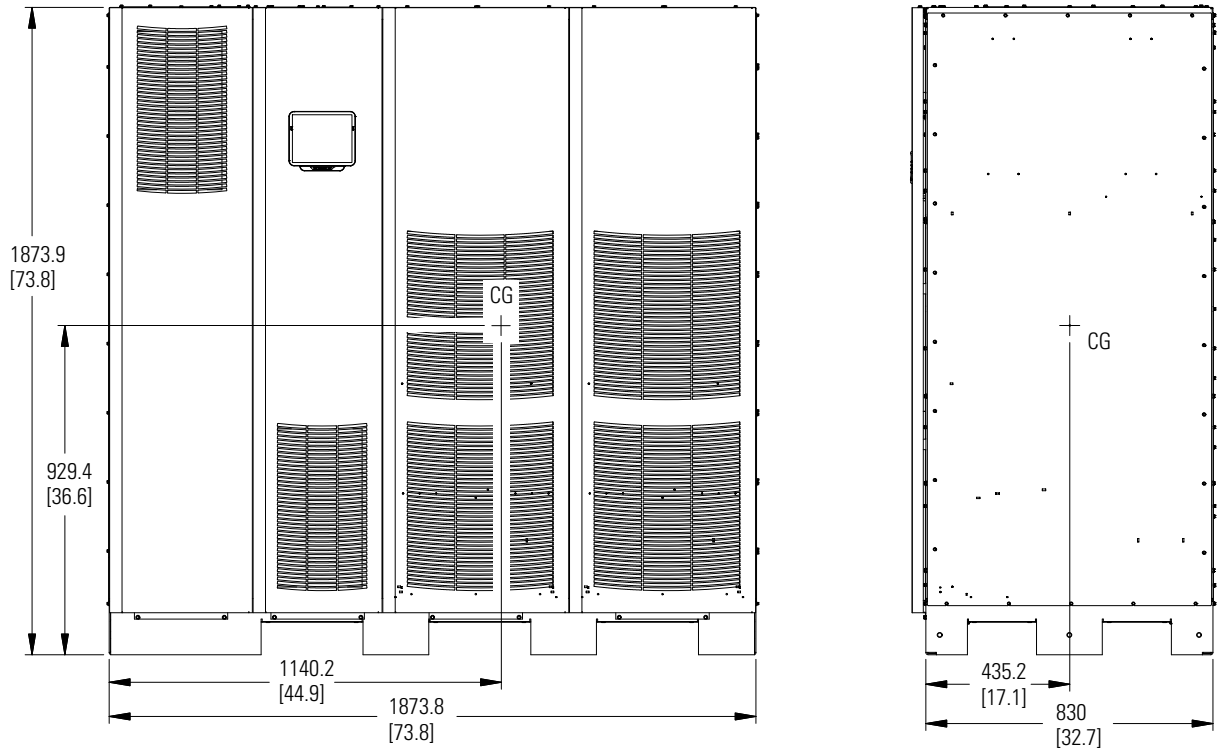

Dimensions are in millimeters [inches].

Figure 3-6. UPS Cabinet Center of Gravity

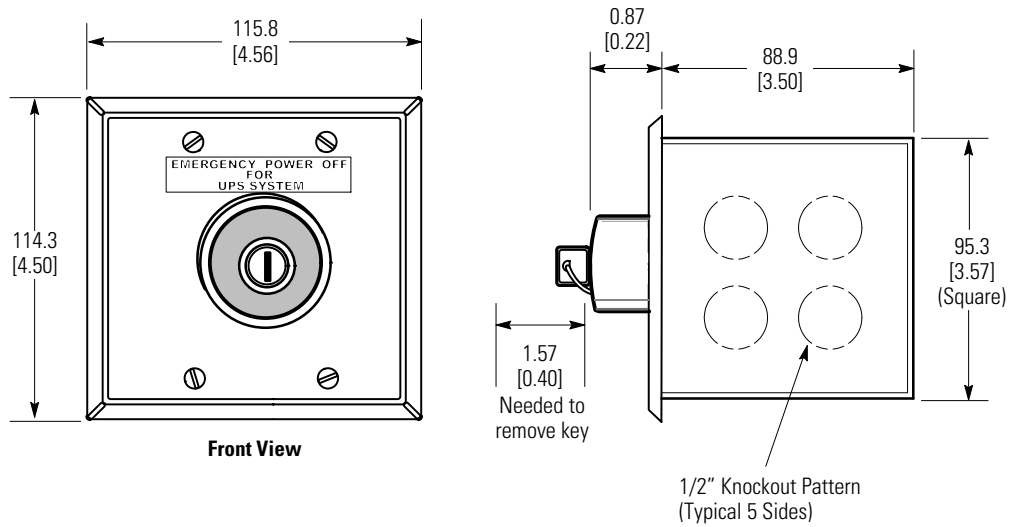

Dimensions are in millimeters [inches].

Figure 3-7. Remote EPO Switch Dimensions